



micropipette for 1:10 dilutions

Acura® 810

Air displacement pipette with two pre-calibrated steps allows subsequent pipetting of 1 and 0.1 mL of the same liquid. Metal nozzle fits long straw tips to aspirate from narrow or deep reservoirs (i.e. Stomacher® bags). Ideal alternative to the graduated pipettes when performing serial 1:10 dilutions in bacteriology.

Product advantages

- Two pre-calibrated fixed volumes - no setting required
- Smooth activation, excellent ergonomics
- Interchangeable PE nozzle protection filter
- **Justip™ system** for height adjustment of tip ejector
- Both volumes calibrated independently
- Easy maintenance, cleaning and disinfection
- Fully autoclavable at 121°C / 250°F

Simple operation

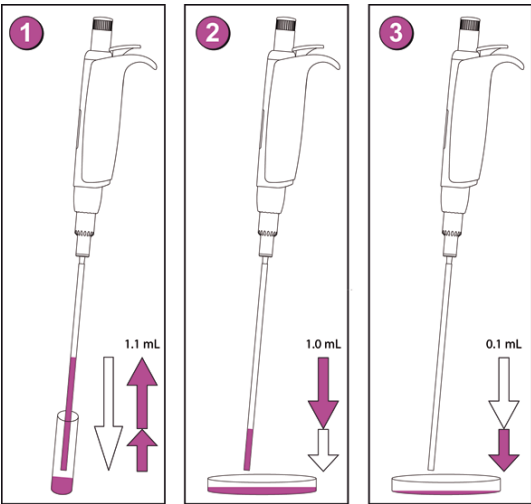

1. Depress plunger button in full, then release slowly to aspirate 1.1 mL
2. Depress plunger button to first stop, thus dispensing 1 mL in Petri dish
3. Depress plunger button to second stop, thus dispensing residual 0.1 mL in next Petri dish

Ordering information - Instrument

Volume	Inaccuracy (E%)	Imprecision (CV%)	Cat. No.
1 + 0.1 mL	< +/- 0.5 %	< 0.4 %	810.1100
	< +/- 2.0 %	< 2.5 %	

Performance values obtained with bi-dist. water at constant temperature (± 0.5°C) comprised between 20 and 25°C in accordance with EN ISO 8655.

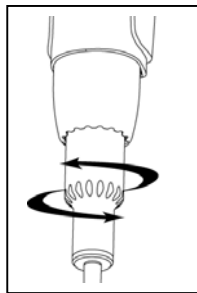

Justip™ ejector
Turn left or right to adjust ejector to tip position on the nozzle

- Straw tips**
- First class polypropylene material
 - 190 mm length >> specially designed for narrow vials and Stomacher® bags
 - 4 mm diameter >> no blocking by particles in suspension

Accessories

Description	Packaging	Cat. Nr.
PP straw tips, sterile	20 x 25 /pack	313.1100
Nozzle filter	100 /pack	322.810
Workstation 340	1 /pack	320.340





Wolflabs

Wolf Laboratories Limited

www.wolflabs.co.uk

Tel: 01759 301142

Fax: 01759 301143

sales@wolflabs.co.uk



Use the above details to contact us if this literature doesn't answer all your questions.

Pricing on any accessories shown can be found by keying the part number into the search box on our website.

The specifications listed in this brochure are subject to change by the manufacturer and therefore cannot be guaranteed to be correct. If there are aspects of the specification that must be guaranteed, please provide these to our sales team so that details can be confirmed.

