

HUURRE

**Made-to-measure
cold rooms**

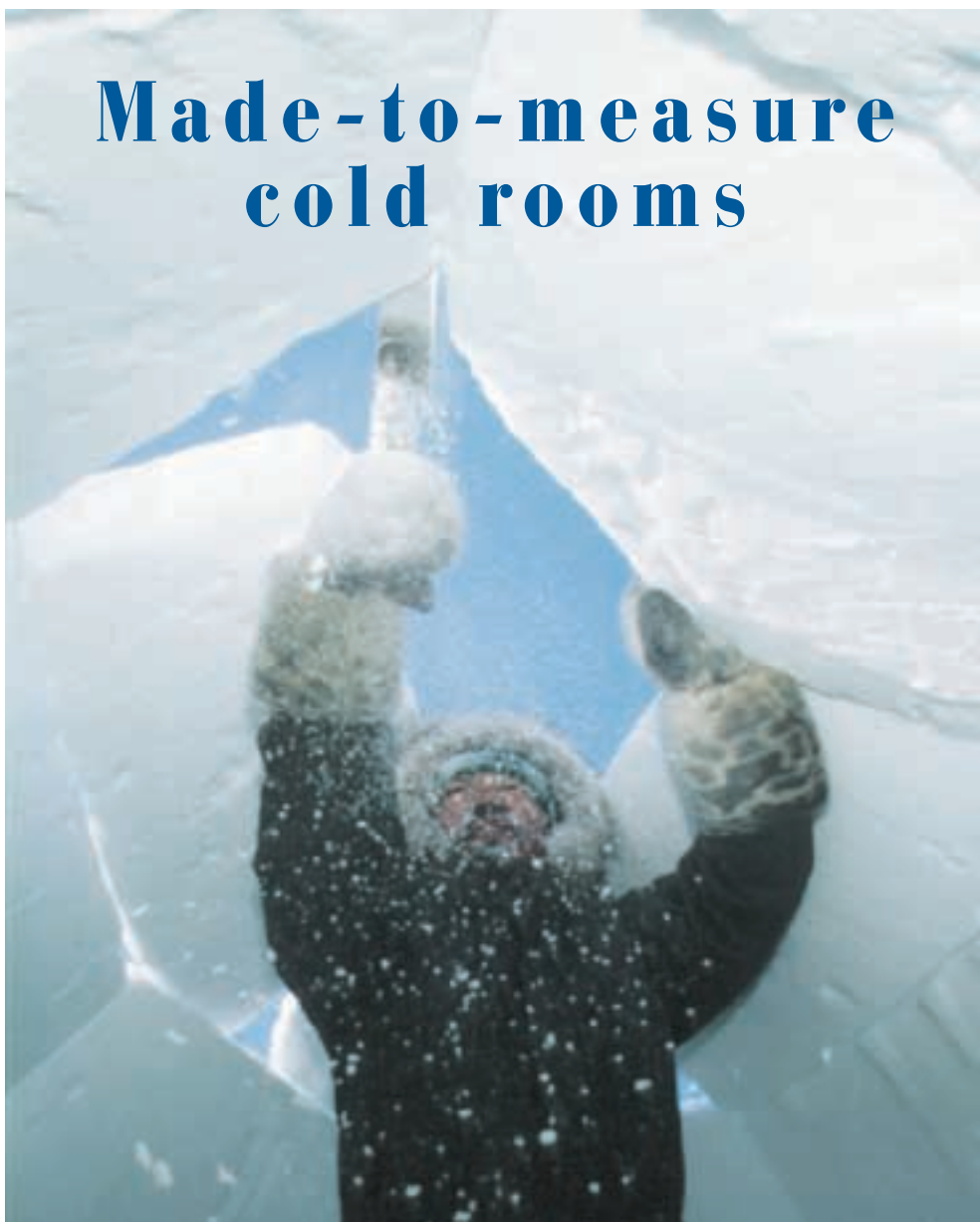

International experts in cold technology

Huurre Group is an international manufacturer of refrigeration products. We make the full range of cold storage equipment, from the smallest refrigerators to large industrial cold stores.

All our customers have their own specific requirements, and these form the starting point for our operations. We design, manufacture and install refrigerated facilities that are made to measure for each site. Huurre's cold rooms are economical to run and products stay in first class condition. We have indepth expertise, with more than fifty years' experience all round the world.

Eco-friendly technology

Huurre Group is at the forefront of developments in environmentally friendly cold storage. One area of special expertise is insulation that is harmless to the environment. We use polyurethane foam in our products, which does not contain CFCs or HCFCs and does not damage the ozone layer or contribute to the greenhouse effect. This insulating material complies with national regulations and the requirements of international agreements, both now and, as far as can be seen, well into the next millennium.

Quality guarantees effective operation

More than half a century's experience in manufacturing refrigerated storage can be seen in our expertise and reliable quality. Our quality system conforms to ISO 9001 standards, providing a guarantee of the quality of our products and services. The system is being constantly upgraded to ensure that the right product is in the right place at the right time, and with the most suitable technology.

Cold and freezer rooms for all purposes

Huurre Group designs and supplies individual cold and freezer rooms for all sectors. These include the food industry, retailers and wholesalers, hotels and restaurants, ships, research institutes, health services and mortuaries. We welcome the challenge from new sectors!



Stores cannot afford second best

Today's consumers expect shopping to be a rewarding experience. For food stores this means that their prices must be right and their premises must be attractive. Shopping itself must be quick and simple.



Every order is a challenge for us

The products in a store must be easily accessible and should look tempting. This is as true for basic food stuffs such as dairy products as for anything else.

Each item of food has a particular temperature at which it should be stored. Any deviation from this temperature lowers the quality – and stores cannot afford to let this happen. Again, the shelves must always look full and tempting. So storage has to be arranged practically, so that filling the shelves is an easy, fast and routine operation.

A cold room with a Huurre cold air curtain is a practical way to sell dairy products. The shelves can be easily set to the required height and the lighting makes the products look very tempting.



The refrigeration chain starts at the factory

The Scandinavian food industry has maintained high standards throughout its history. Consumers everywhere in the world have learnt to trust Scandinavian quality. The finished product is well made and tastes delicious.

Only first class ingredients are used in products. The production process itself is strictly controlled from start to finish. Overall hygiene is a key factor, and so is the correct temperature.

An unbroken refrigeration chain is needed, starting at the factory in its raw materials storage and in production. The temperature must be kept stable.

Our cold rooms are always made-to-measure for each site.



Cool enough even on the equator

Many luxury cruise ships sail in the southern hemisphere, as places of entertainment for passengers with high expectations. In these surroundings, the food that is served, and how it is stored, is a matter of considerable importance.

The luxury liners sailing the oceans form a world of their own. The people on these cruises are looking for genuine experiences, and want everything to be of the best quality. These ships represent elegance in every respect – even their cold stores are coolly elegant.

It takes special knowhow to design and manufacture cold stores for ships. The extremely high standards for hygiene require special solutions, in which we have many years' experience.



The world is shrinking, demands are growing

Fast food is always fast food, in every corner of the world. In its classical forms, it is the absolute number one for many people. Hamburgers and pizzas are a delicacy - millions of people can't have got it wrong!

The correct temperature in storage ensures that the ready food is of the highest quality, and tastes delicious.

Cold stores have become a key factor in the production of hamburgers. Minced meat and the other hamburger ingredients need to be stored very carefully. It is important for them to be kept at the correct temperature.



Made to measure

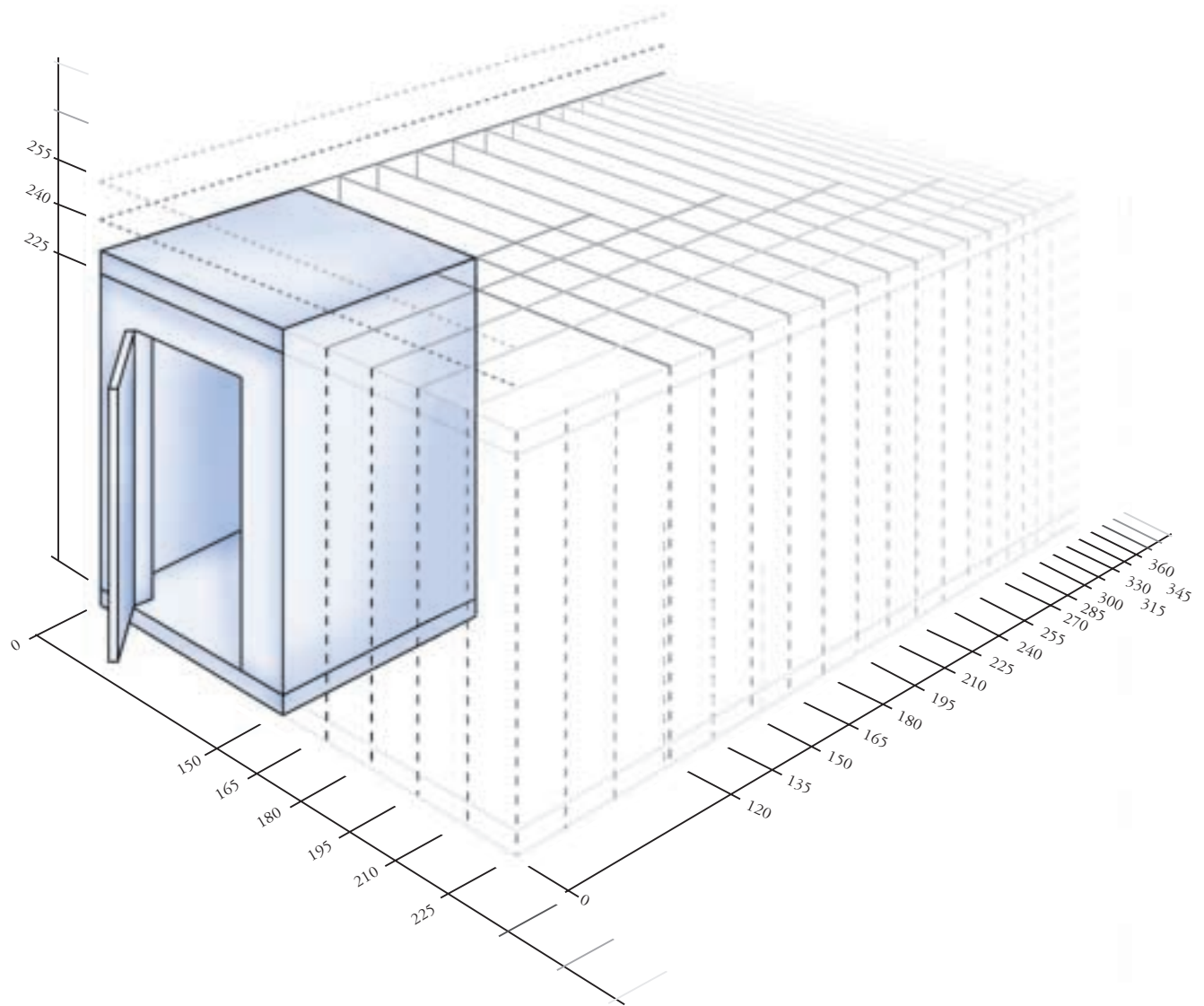

We make cold and freezer rooms to measure. Because of the modular construction, the best overall results are obtained when the external dimensions are multiples of 150 mm. We also recommend that the internal height is a figure divisible by 150 mm.

Thermal conductivity factor and weight of panels

| <i>Thickness of insulation mm</i> | <i>Thermal conductivity factor (ave.) W/m²K</i> | <i>Weight kg/m²</i> |
|---------------------------------------|--|------------------------------------|
| 75 | 0.29 | 13 |
| 100 | 0.22 | 14 |
| 150 | 0.15 | 16 |

Suitable materials for different uses

The insulating material is rigid polyurethane which is foamed in a mould. It is free of CFCs and HCFCs and has a density of 40 kg/m^3 . The standard facing for the panels is 0.6 mm galvanized steel sheet, coated with white (RAL 9010) foodsafe polyester. The facing can also have a PVF_2 coating or can be of stainless steel, but these need to be specified separately. For special orders thicker sheet can be used, up to 1.0 mm.

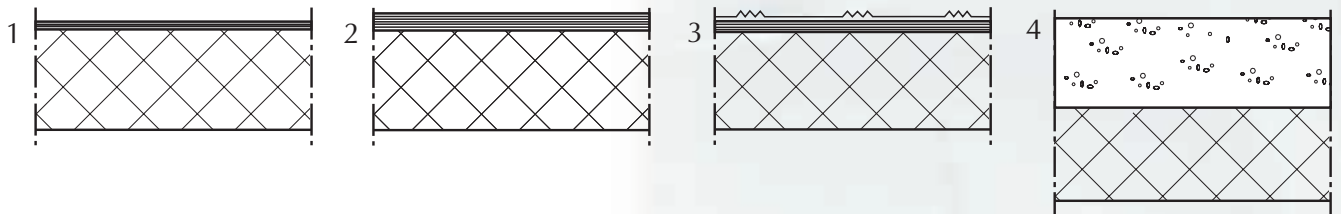

The floor panels have inbuilt insulation, a vapour barrier and surface material, and can be fitted with heating wires to protect against ground frost if necessary. The standard flooring has a 9 mm non-slip plywood facing (1), which is suitable for pedestrian traffic and trolleys with rubber tyres. The alternatives are 15 mm non-slip plywood (2) or 3 mm crimped aluminium, with plywood underneath. If fork-lift trucks are used in the room, then the floor surface should be of concrete slabs.

Panel structure

Panels have a maximum width of 1.2 metres and length of 6.0 m. The panels are joined together with quick action locks, which speed up erection work. The system also includes corner panels, to form the links at corners, and T-panels for partition walls. If the floor panels of a freezer room are placed on a floor that is directly on the bare earth, and it has no other protection against ground frost, the floor panels are fitted with electric heating wires.

Fittings for refrigerator and freezer rooms

- Hinged, sliding or swing doors are available. The steel facing of the doors, apart from the swing doors, is of galvanized steel sheet with a polyester coating or of stainless steel sheet. The insulation is polyurethane foamed in a mould.
- The heights of the shelves can be steplessly adjusted and they have three depths, 330 mm, 430 mm and 530 mm. The shelves are made of galvanized steel sheet painted white or, for special orders, of stainless steel sheet.
- The refrigeration machinery is either installed on site or can be a factory assembled refrigeration unit.
- The cold air curtain is for selling dairy products direct from a cold room. It is supplied with the cooling equipment, adjustable height shelves, lighting, rear sliding doors and a motorized overnight front curtain.
- Various practical accessories are available, to make it easier to use the rooms and monitor the temperature. These include door ramps, thermometers and cold air fans for door openings.

A practical design depends on its components

Our refrigerator and freezer rooms are turnkey deliveries that are built according to the requirements of each site and customer. The dimensions are determined for each case separately and so is the standard of the fittings. The delivery includes the floor, wall and ceiling panels and the doors, which can be chosen from our wide selection. Pressure balancing valves are included for freezer rooms.

The delivery can also include the refrigeration equipment and other accessories. These include shelves,

cold air curtain, windows, door curtain fan, and a whole range of accessories that make it easier to use the room and monitor the temperature.

Ask our sales people for more details.

Erecting the cold store is easy, since all necessary fittings come with the delivery, along with clear instructions. But if you wish to make sure that erection is as fast and troublefree as possible, we will carry it out for you, or we will supervise the work.

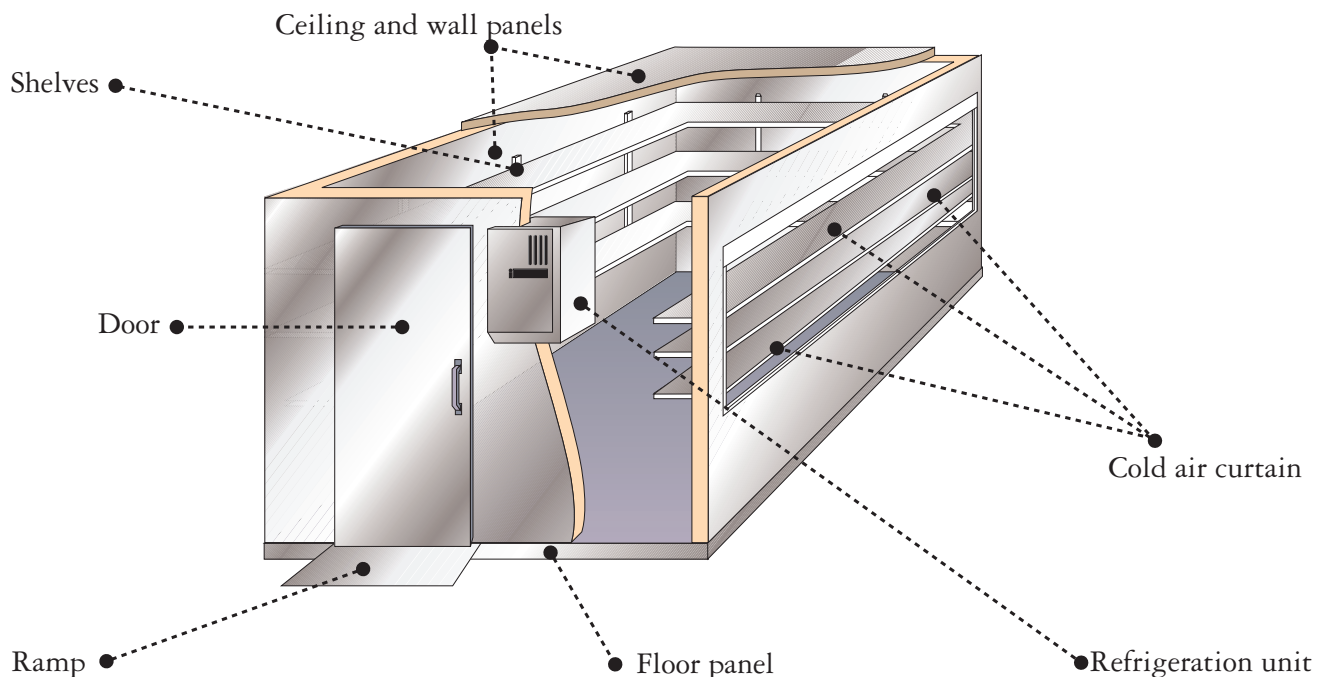

Hurre Group is simply better

A Hurre cold room is a simple and safe choice, since all the components come from the same supplier. The dimensions can be freely chosen; they are specified separately for each customer, to the nearest 150 mm. With their modular structure and quick action locks, the cold stores are easy to alter and expand. Foodsafe facing materials and the well designed structure help to make the rooms hygienic. The CFC and HCFC free polyurethane insulation is environmentally friendly and cuts energy costs.



HUURRE G r o u p

Huurre Group Oy

Head Office

P.O. Box 127, FIN-33101 Tampere, Finland

Tel. +358 3 38 800 Fax +358 3 388 0360