

EXTRACTOR KIT 3000



EK 3000 is quickly and easily installed and creates a workplace where fumes and gases are efficiently captured.

The arm is made of aluminium and plastic and has three adjustable joints. One hand adjustment and no particular strength is needed to adjust and position the arm close to the source.

The filter efficiently absorbs the noxious fumes and gases that normally occur when soldering, gluing and working with solvents. The filter is disposable and the filter change is made dust free.



The arm is quickly mounted with the flexible bench bracket and within a couple of minutes the Kit is ready for use.

The speed of the fan can easily be adjusted with the speed controller, to suit different applications. A number of different hoods can be used to increase the capture ability.

Extractor Kit 3000

Part.no. 512634

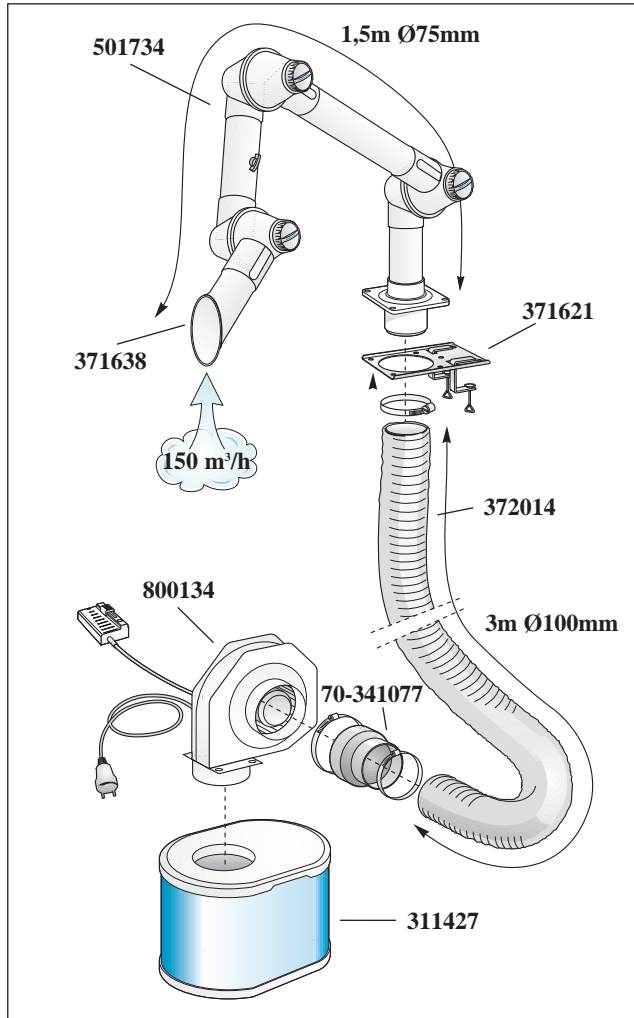

Accessories

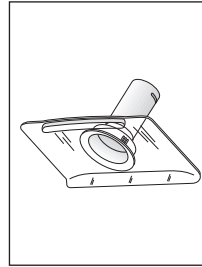

Flange hood
WxH: 300x200mm
Part.no. 371641

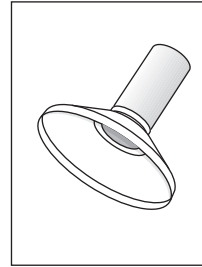

Metal hood
Ø 250 mm
Part.no. 371643

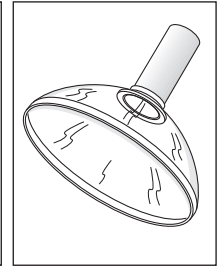

Dome hood
Ø 350 mm
Part.no. 371642

For further accessories see "Miniarm FX".

Technical data

Voltage:	230 V
Power:	127 W
Soundlevel:	60 dB(A)
Filter efficiency DOP:	99.97 %
Weight filter/fan:	8.0 kg
Height filter/fan:	555 mm
Length filter:	388 mm
Width filter:	288 mm

PRODUCT LEAFLETS

Nederman has a wide range of products for capture and filtration of particles, fumes and gases. See separate product leaflets for more information.

