

FUME CABINETS

Nederman Fume Cabinets are transparent and therefore do not obscure the working area. Suitable for daily storage and preparation of harmful liquids in bottles and open vessels. They are manufactured from polycarbonate (FC35 in PETG) and delivered complete with hose connections.

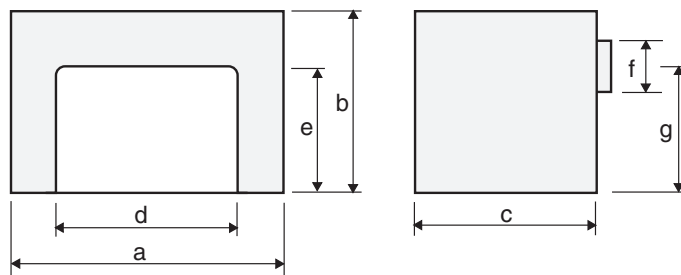

| | FC100 | FC60 | FC40 | FC35 |
|---------------------------------|----------|----------|----------|----------|
| Part no. | 70371648 | 70371647 | 70371646 | 70371750 |
| Width (a), mm | 1000 | 600 | 400 | 350 |
| Height (b), mm | 700 | 400 | 350 | 250 |
| Depth (c), mm | 500 | 400 | 300 | 200 |
| Aperture (d x e), mm | 700x600 | 500x300 | 300x250 | 300x140 |
| Connection Ø (f), mm | 2x160 | 125 | 100 | 32 |
| Connection C/L (g), mm | 250 | 150 | 100 | 80 |
| Rec. airflow, m ³ /h | 750 | 270 | 130 | 50 |

| | | | | |
|---------------|------|------|------|------|
| Recovery rate | 100% | 100% | 100% | 100% |
| Weight, kg | 12 | 3,5 | 2 | 1 |

On request the connection stub can be placed elsewhere

Improving your workspace