



point of use

□ HS55 (left) and HS75

HS 55 features

- Robust outer case for use in various applications.
- Water temperature is adjusted internally and a replaceable thermal fuse provides protection against overheating.
- Durable inner copper container for long life.
- Foam insulation ensures low standing heat loss.
- The HS 55 can be mounted undersink, using vented hot taps. When mounted undersink, the unit should be mounted upright with inlet and outlet below the heater.
- 7 litre and 10 litre models, a 1.2Kw model is available for areas of restricted electrical load.

HS75 features

- Superb styling and design to complement any hot water installation.
- Maximum, dishwasher, handwash and minimum heat settings, allowing temperature to be set for the specific use.
- Heavy duty polypropylene water container and high insulation levels minimise standing heat loss and wasted energy.
- Remote model available including separate outlet and air switch operated solenoid valve. Avoids the use of specialised vented taps (see diagrams) in an undersink installation. The Remote unit is supplied complete and must not be fitted with taps.

MODEL HS55	3N	1N	10N
CAPACITY Litres	7.0	7.0	10.0
RATING Kw	3.0	1.2	3.0
ELEMENT: Copper Tube			
INSULATION: Injected polyurethane foam			
COVER: Powder coated steel			
SAFETY: Replaceable thermal fuse			
THERMOSTAT: Adjustable stem type			
DIMENSIONS h	356	356	440
mm	w	240	240
inc spouts	d:	240	240

BEAB approved. WRC listed.

CHROME TAPS HS55/75	
Basin Pillar Mixer	
HOT VENTED	TXH01 TXH02 TXM01
COLD	TXU01 TXU02 TXM01

Not Remote model.

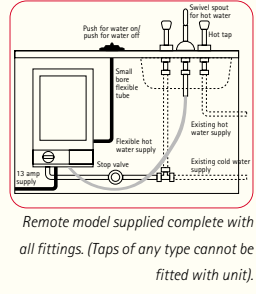
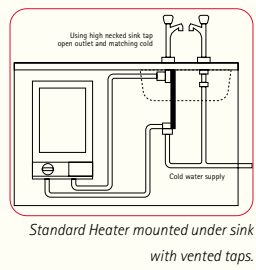

MODEL HS75	75 3	75 3R	75 1
	STANDARD	REMOTE	STANDARD
CAPACITY Litres	7.0	7.0	7.0
RATING Kw	3.0	3.0	1.0
ELEMENT: Incoloy 800, suitable for aggressive water areas			
INSULATION: Corrosion resistant polypropylene container with polystyrene jacket			
SAFETY: Over temperature thermal fuse			
HIGH PRESSURE: Insert restrictor supplied to prevent undue cold/hot mixing			
DIMENSIONS mm	h:466 w:286 d:165		

BEAB approved. WRC listed.